

YS Super Mount 3 (DZ185,175,170,160)

FEATURES

Equipped with an oil damper and soft rubber rings front and rear will dramatically reduce vibration and noise compared to conventional engine mounts. Limiting the engine only to pivot around the center line of the crankshaft will minimize spinner wobble and reduce airframe vibration.

INSTALLATION

1. Install the Damper ball support #6 to the carburetor body using liquid thread lock and secure in place.
2. Install #3 rear mount assembly using #4 screws.
3. Install #5 oil damper as shown in drawing.
4. Install #2 front nose ring assembly by sliding it over the engine case.

Note: DO NOT ALLOW ENGINE DRIVE WASHER TO RUB ON NOSE RING.

5. The engine is now ready to be installed in the airplane.
6. The engine will vibrate from side to side. You will need to make the proper clearance under as well as on top of the engine. If the engine is able to hit the airframe this may cause damage to the engine and or airframe.

HOW TO OPERATE

1. Since the engine will vibrate from side to side, make sure it will not hit the airframe at any time. The engine will vibrate the most during the time it is at idle and at full throttle the engine will subside and lean to the left (viewing it from the front) due to the torque of the engine.
2. The Oil Damper is filled with oil and can be changed to a different grade of oil to suit your performance. The oil used at the YS factory is Tamiya Damper Oil #600.

MAINTENANCE

1. The YS Super Mount was designed to absorb vibration and should be checked regularly making sure nothing is abnormally loose or broken.
2. Adding or changing the damper is done by first removing it from the engine mount. Hold the widest part of the damper straight up edge and reinstall the cap.

SAFETY PRECAUTIONS

1. Always check and secure the mount on a regular basis.
2. Do not use if any part of the mount is loose or broken.
3. The YS Super Mount is an accessory unit for the DZ170, DZ160, DZ140, FZ140-2 and follow the precaution for safe operations of your engine manual.

WARRANTY

Should this product fail to function properly during normal operations for the time period of one year, we will repair it without charge in the limited cases where the malfunction can be deemed attributable to a manufacturing defect. Any modification to the YS Super Mount will void all warranty.



YAMADA MFG.CO.,LTD.

67 Tsuchitori Inuyama Aichi Japan

TEL: 0568 67 0265 FAX: 0568 67 7801

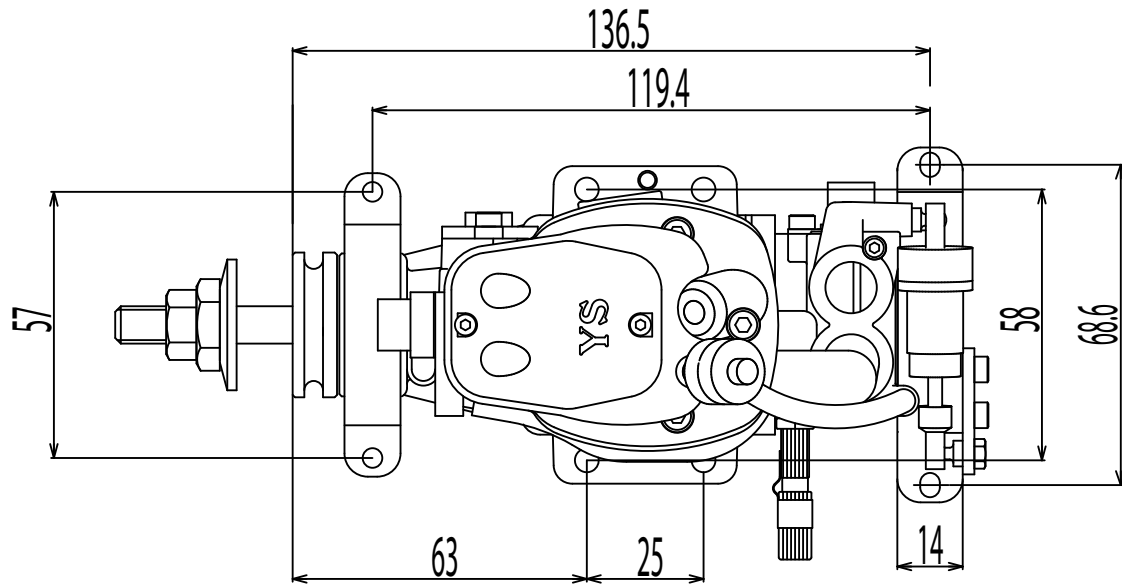

	Parts No.	Description	QTY
1		Engine	1
2	M0020	Nose Ring Assembly	1
	M0021	Nose Ring Inner Case	1
	M0022	Nose Ring Inner Rubber	1
3	M2030	Rear Mount Assembly	1
	M2031	Rear Mount	1
	M0032	Rear Mount Arm	1
	M0033	Rear Mount Arm Screws	2
4	M0040	Rear Mount Screws	3
5	M0060	Oil Damper	1
6	M0070	Ball Support	1
	MN140	TeflonTape	1

